

Fixing Instructions

Sterling

3 Lever Mortice Sashlock and Bathroom Mortice Lock

1. Position lock centrally on door and mark off body on the edge and both faces of door. Cut slot to suit lock ensuring a snug fit.

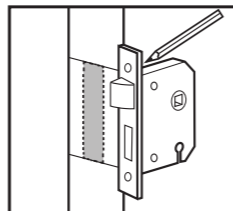

2. Insert lock and mark position of front faceplate recess.

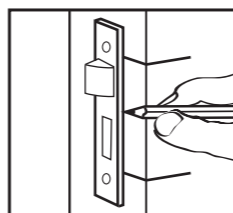

3. Using lock as template, mark off positions of keyhole and follower. Drill and cut on both sides of door. Insert lock, position face plate and fasten with screws provided and test operation of lock and latch.

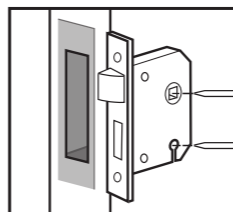

4. With door open, turn key to locked position. Close door onto frame and mark positions of 'Dead Bolt' and 'Latch Bolt'.

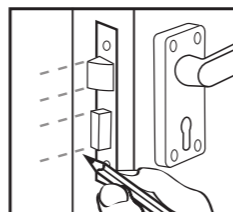

5. Mark out and cut slot in frame to accommodate flat strike plate. Fix the plate, recess flush with frame if required. Part secure plate initially to test lock operation. Complete fixing.

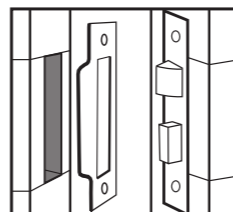

Instructions for reversing the bolt (if applicable)

- a) Remove the face plate cover
- b) Rotate latch bolt one half turn (180°)
- c) Replace face plate cover

Sterling Locks Limited
Leeds Bradford Airport Industrial Estate
Harrogate Road, Yeadon, Leeds LS19 7WP
www.sterlinglocks.com

