

Installation Instructions

A. The closer should be attached vertically to the door jamb on the hinged side of the door or gate.

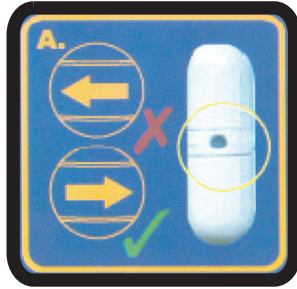

B. Turn the centre of the closer in the opposite direction to the arrow to set the tension. Beware of over tensioning as this may cause the door or gate to slam causing injury or may damage the spring.

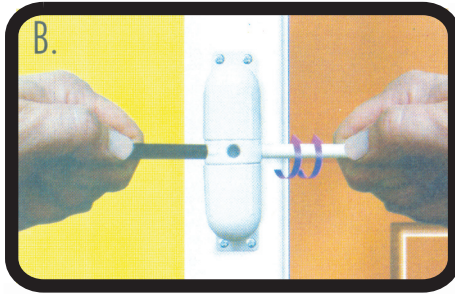

C. Locate the hole nearest the door or gate and insert the arm.

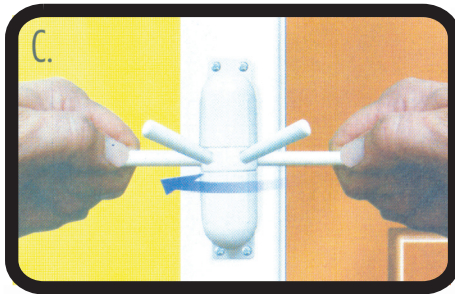

D. To protect the door or gate make sure the slide plate is fixed into position on a flat surface.

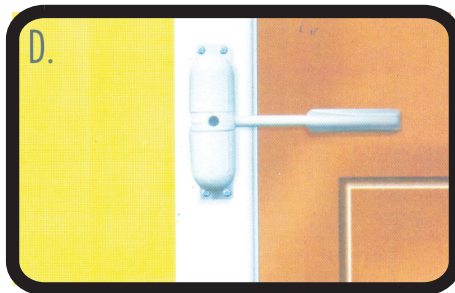

E. Using the steel bar supplied to adjust the tension turn the centre boss away from the door or gate. Locate the hole nearest the door or gate and screw in the arm. Repeat this operation one hole at a time to increase the tension.

Installation Instructions

A. The closer should be attached vertically to the door jamb on the hinged side of the door or gate.



B. Turn the centre of the closer in the opposite direction to the arrow to set the tension. Beware of over tensioning as this may cause the door or gate to slam causing injury or may damage the spring.

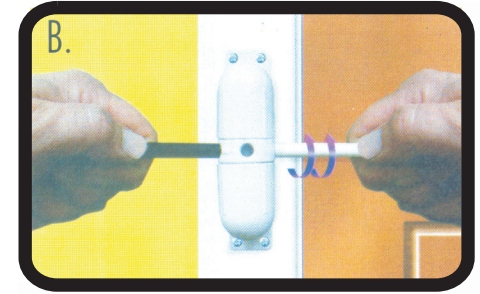

C. Locate the hole nearest the door or gate and insert the arm.

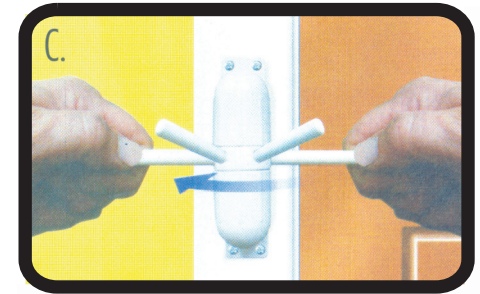

D. To protect the door or gate make sure the slide plate is fixed into position on a flat surface.

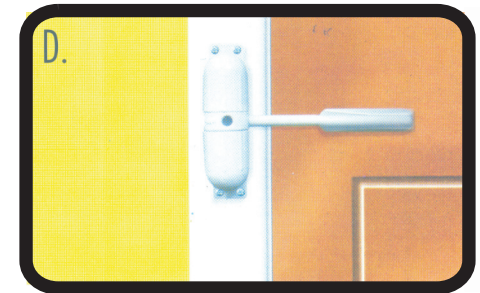

E. Using the steel bar supplied to adjust the tension turn the centre boss away from the door or gate. Locate the hole nearest the door or gate and screw in the arm. Repeat this operation one hole at a time to increase the tension.