

## LOCATION OF CONTROLS

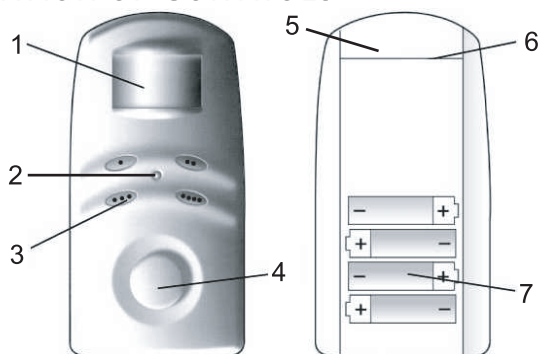

- |                          |                          |
|--------------------------|--------------------------|
| 1. Motion sensor         | 5. AC adaptor socket     |
| 2. Battery low indicator | 6. External siren socket |
| 3. Keypad                | 7. Battery compartment   |
| 4. Siren                 |                          |

## BATTERY INSTALLATION (See picture below)

Access the battery compartment on the rear of the unit by removing the screw at the base of the alarm unit and lifting the bottom of the back plate as shown in the figure below. Insert four (4) "AA" alkaline batteries (not included) following the polarity diagram. When the last battery is inserted, the unit will beep **very** loudly to indicate the batteries are installed properly. Then, replace the back plate. Because of this unit's unique design, it does not require a battery cover.

## BATTERY LOW INDICATOR

The little red indicator will light when the batteries need replacing.

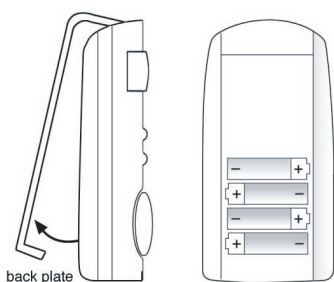

## PROGRAMMING THE ALARM

Immediately after inserting the batteries, the desired 4 digit code must be set. To set the code, simply press the desired 4 digits on the keypad (e.g. 1,2,3,4 or 2,3,4,1), any 4 digit number of your choice.

Note : The alarm must be re-programmed with your personal code every time the batteries are removed and replaced. After removing the batteries, you need to press the keypad number 4, before installing the new batteries in order to avoid false alarm.

## INSTALLATION

Choose the desired location, remove the back plate and secure it to the wall using the supplied screws (see figure). The unit can now be snapped into place onto the back plate and secured by fastening the screw on the bottom of the unit. The unit is also free standing.

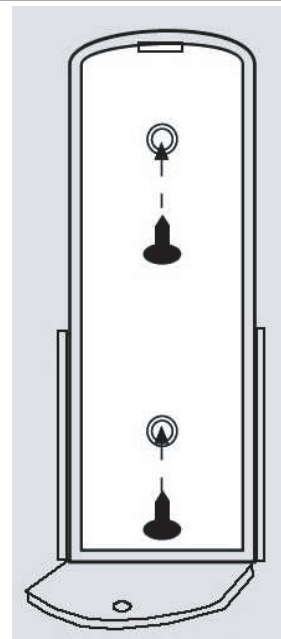

## OPERATION

### Arming the alarm

On leaving the protected area, press keypad number 4, and a short "beep" will be heard; this will arm the unit. There will be a delay of 30 seconds to enable you to leave the protected area before the alarm sounds. If the unit detects motion, it will sound an alarm

### Disarming the alarm

On returning to the protected area, simply press your personal alarm code within 10 seconds. This will disarm the unit. If incorrect code or no code is being entered, the alarm will sound for approx. 30 seconds and then will reset itself automatically. If the unit detects movement, the alarm will sound again for another 30 seconds.

**WARNING: THE ALARM SIREN IS VERY LOUD, PLEASE DO NOT LET IT SOUND FOR LONG LENGTHS OF TIME**

## Troubleshooting

- The unit does not sound when the batteries are installed.  
*Ensure the batteries are inserted correctly, following the diagram inside the battery compartment*
- The alarm does not arm.  
*Ensure that you have set the personal alarm code when replace the new batteries*
- The red light on the unit is on.  
*This is "Battery low indicator". The old batteries should be replaced with new batteries.*
- The alarm sound stop after approx. 30 seconds.  
*This is normal, the alarm is reset to normal detection mode, once motion detected. Alarm will sound for another 30 seconds.*
- After enter 4 digit code, no beep sound  
*Before you put in new batteries, press any keypad number few times to discharge the unit, then replace new batteries, then press new 4 digit codes.*